



**MACHINE ROOM (MRA)  
MID-RISE PASSENGER LIFT**



**GEARED TRACTION MACHINE  
ROPING 1:1**

LIFT SHAFT - SECTION VIEW

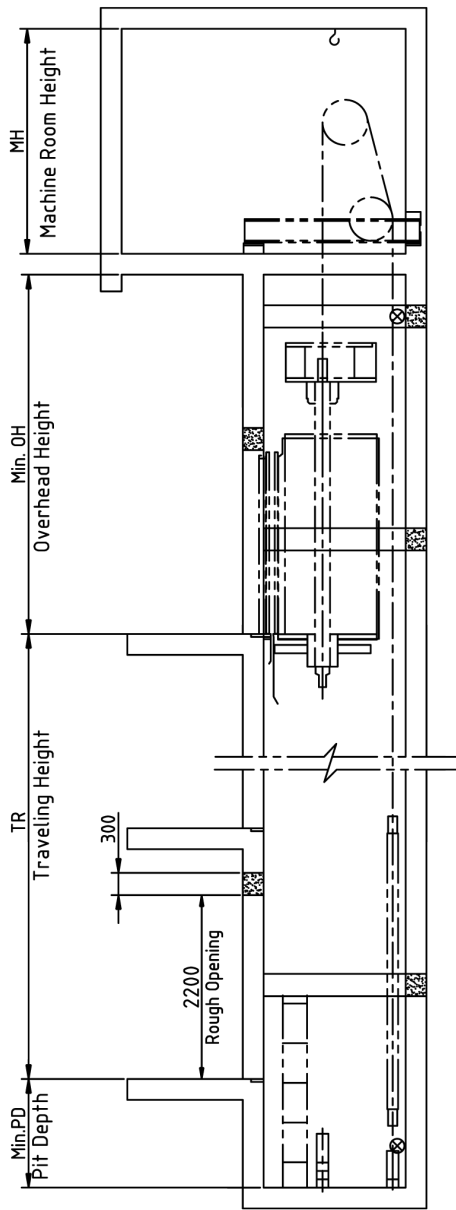

MACHINE ROOM PLAN

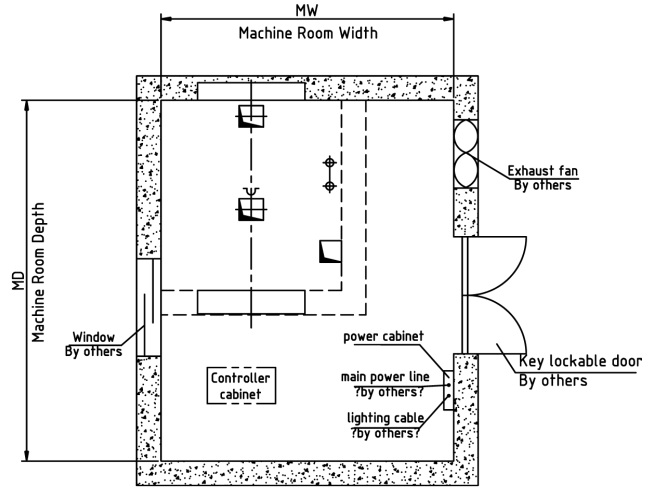

MACHINE ROOM PLAN

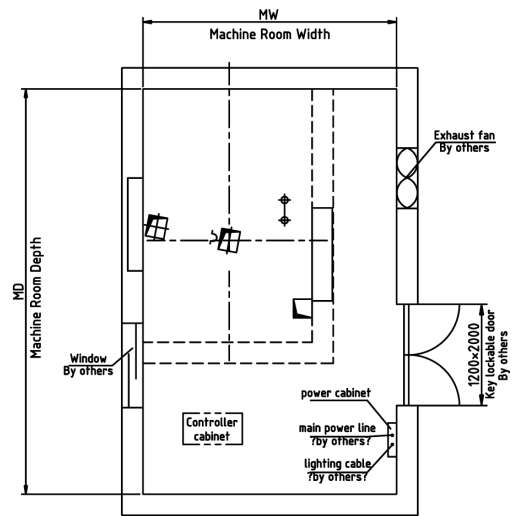

HOISTWAY PLAN

Wide Car Type

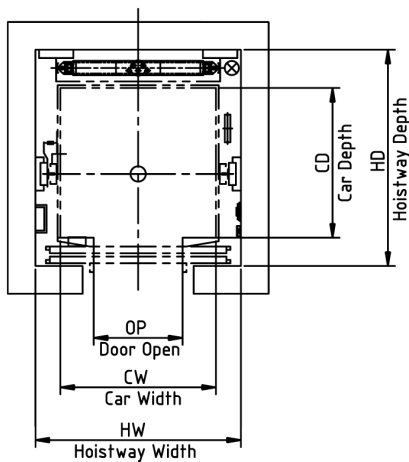

HOISTWAY PLAN

Deep Car Type

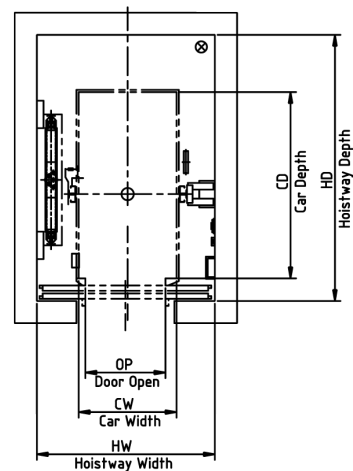

**MACHINE ROOM (MRA)  
MID-RISE PASSENGER LIFT**

CAPACITY		CAR			DOOR		SHAFT	
Load	Person	Type	Width	Depth	Type	Opening	Width	Depth
kg	P	CT	CW	CD	DT	DO	HW	HD
630	8	Wide	1400	1100	2CO	800	1850	1700
800	10	Deep	1100	1700	2CO	800	1950	2150
		Wide	1400	1350	2CO	800	1850	1950
900	2000							
1000	13	Deep	1100	2100	2CO	800	1850	2550
		Wide	1600	1400	2CO	900	2050	2000
1000	2200							
1150	15	Deep	1400	1800	2SO	1100	2300	2250
						1200		
		Wide	1800	1400	2CO	1100	2400	2100
1250	16	Deep	1400	1950	2SO	1100	2300	2400
						1200		
		Wide	1950	1400	2CO	1100	2550	2200
1350	18	Deep	1400	2100	2SO	1100	2300	2550
						1200		
		Wide	1950	1500	2CO	1100	2550	2300
1600	21	Deep	1400	2400	2SO	1100	2300	2850
						1200		
		Wide	1950	1700	2CO	1100	2550	2500

*Max. Travel: 75m*

Speed	Capacity	Overhead	Pit	Car Clear Height	Door Height
m/s	kg	mm	mm	mm	mm
1.0	450-1000	4300	1300	2200 with suspension ceiling	2100
	1150-1600	4400	1500		
1.5	450-1000	4400	1400		
	1150-1600	4500	1600		
1.75	630-1000	4500	1500		